

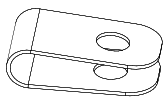

Instructions for Moultrie Varmint Guard II

Thank you for your purchase of a Moultrie Varmint Guard II. Please read this sheet before operating the unit. If you should have any questions about this product or any other Moultrie product, please contact us using the information on the back of this sheet. Allow us to better serve you by activating your 1-year warranty online at <http://www.moultriefeeders.com/warranty>.



U-clips
Qty. 12

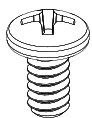

Screws
Qty. 12
(M3.5X0.7X8)

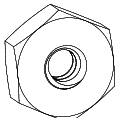

Nuts
Qty. 12
(M3.5x0.7)

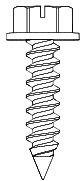

Lag Screws
Qty. 3
(M6X1X20)

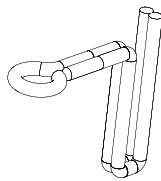

Mounting Brackets
Qty. 3



Carabiner Clip
Qty. 1

A ASSEMBLE VARMINT GUARD II

1 Remove Varmint Guard from packaging, cut zip-ties off and un-fold all the panels.

2 With the hexagon base flat on your workstation, fold the side-panels up and then around the base to connect the first and last panels.

NOTE: Ensure that the panels are folding counterclockwise (CCW) around the base.

3 Secure the first and last side-panels together using one (1) U-clip, screw and nut.

OPTIONAL: Repeat step 3 for the remaining panels for added stability.

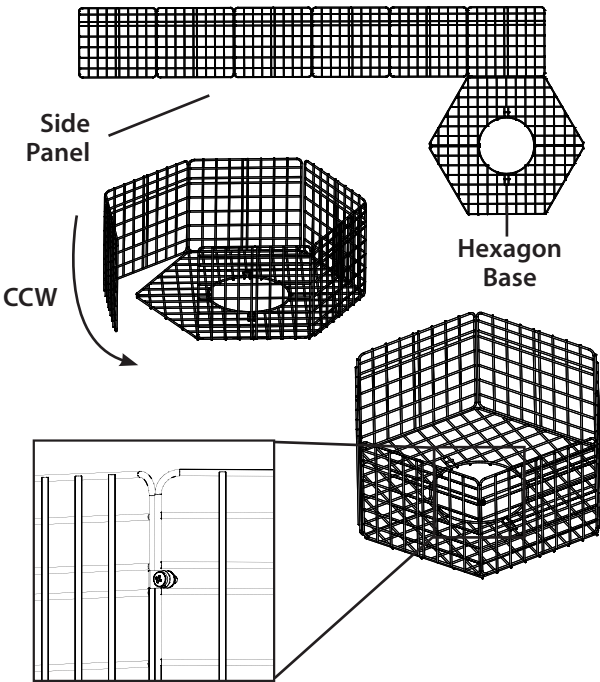
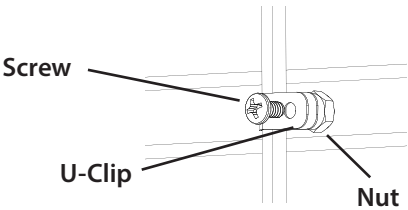

4 Secure the bottom of each side-panel to the hexagonal base using one (1) U-clip per panel (6 total). See picture for U-clip fastening locations.

NOTE: Save this step for last if feeder kit can not be removed before final installation of Varmint Guard II.

5 Choose any 1 of the 6 side-panels to begin the mounting bracket install.

325 FEEDER ONLY - Using a pair of pliers, give the mounting brackets a slight crimp in the U-channel. This will help keep them in place during mounting of the Varmint Guard.

NOTE: BE SURE NOT TO OVER CRIMP. THIS WILL NOT ALLOW ENOUGH ROOM FOR INSTALLATION ONTO THE VARMINT GUARD.

30 GAL FEEDER - If bracket is too difficult to install, bend bracket outwards into a "V" shape for insertion then crimp once in place.

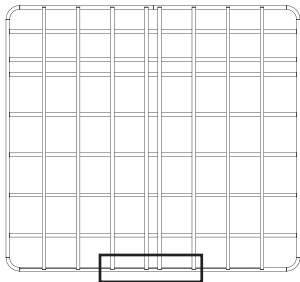

U-Clip fastening locations

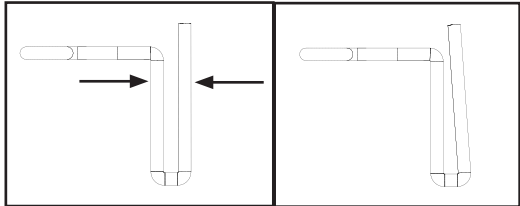

325 Mounting Bracket crimping

From the **INSIDE** of the Varmint Guard, slip the mounting bracket U-channel between the middle vertical rails of the chosen side-panel and slide it upward into the correct support rail.

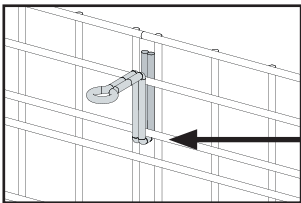

30-GAL FEEDER:
Mounting bracket U-channel will clip to the **top support rail** (3rd rail from top)

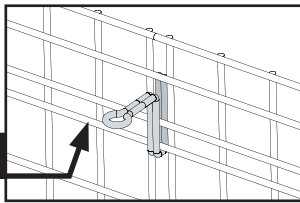
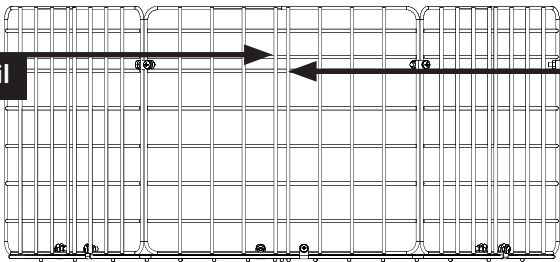

325 FEEDER:
Mounting bracket U-channel will clip to the **bottom support rail** (4th rail from top)



- 6** Repeat previous step 2 more times, skipping a panel between each bracket. There should be 3 side-panels fixed with mounting brackets, with a bare side-panel between each one.

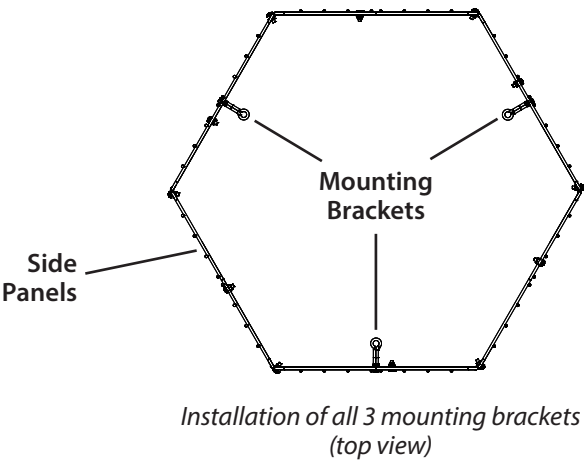

- 7** **BEFORE** installing Varmint Guard to hopper, pre-thread the lag screws into the pre-marked holes in the 3 flat pads of the hopper and then remove them to make installation easier.

CAUTION: DO NOT OVERTIGHTEN OR YOU WILL STRIP THE HOLES!

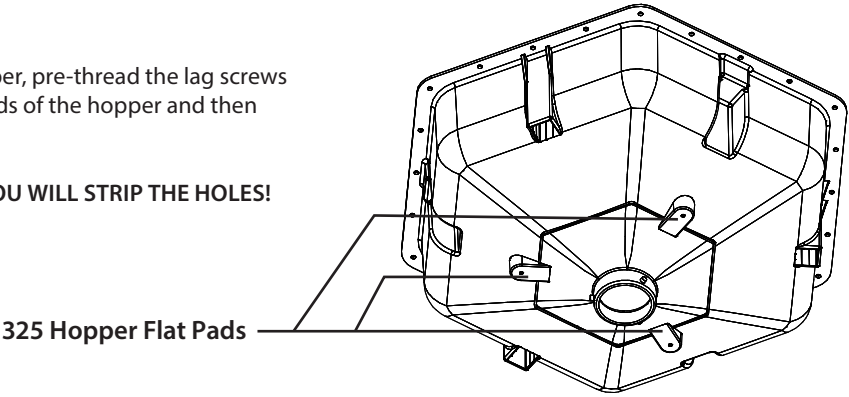

- 8** While holding the Varmint Guard up to the hopper, align the mounting bracket eyelets with the pre-threaded holes from **STEP 7**. Insert the lag screws through the eyelets and into the pre-marked holes on the hoppers flat pads using a Phillips Head Screwdriver (or a Ratchet Wrench with a 10mm socket, extension optional) and tighten until Varmint Guard is secure.

CAUTION: DO NOT OVERTIGHTEN!

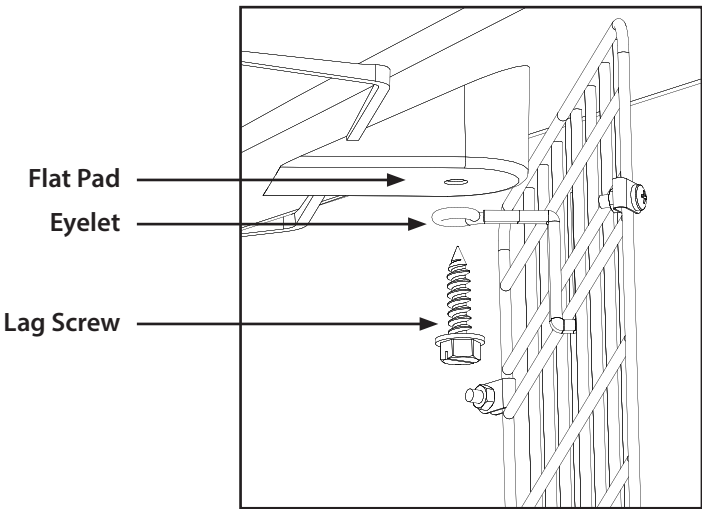

- 9** You are now ready to install your Feeder Kit.

B FOR ALL-IN-ONE KITS ONLY

- 1** Attach square-gate hooks to the Hexagon Base so that the gate can swing upwards into the base locking slot, then attach the carabiner clip through the eyelet.

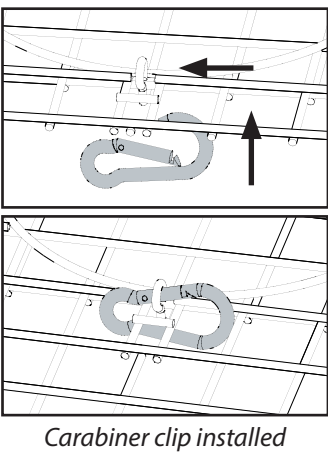
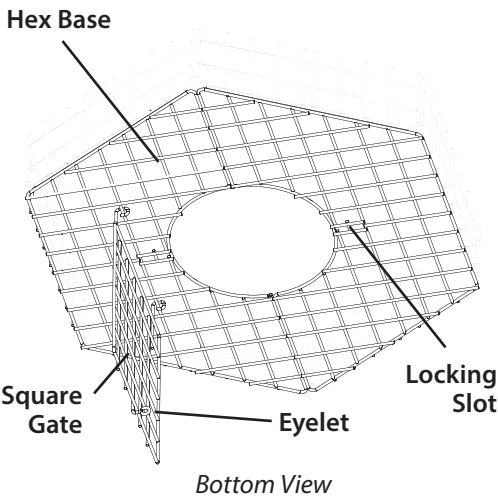
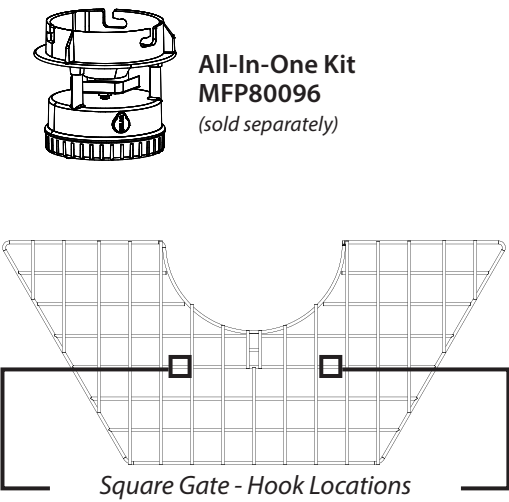

Our Service Department will gladly answer any questions you have.
www.moultriefeeders.com/support