



Instructions for Moultrie Wildlife Directional Kit with Programmable Digital Timer

THANK YOU for your purchase of a Moultrie Wildlife Directional Feeder Kit. Please read this sheet before operating the unit. If you should have any questions about this product or any other Moultrie product, please contact us using the information on the back of this sheet. Allow us to better serve you by activating your 1-year warranty online at <http://www.moultriefeeders.com/warranty>

A PREPARING TO ATTACH FEEDER CHUTE

Remove the hardware shown in circled areas using a 4mm hex key (Allen wrench).

This hardware is required to be removed before attaching the chute, and will be reused to attach the feeder chute.

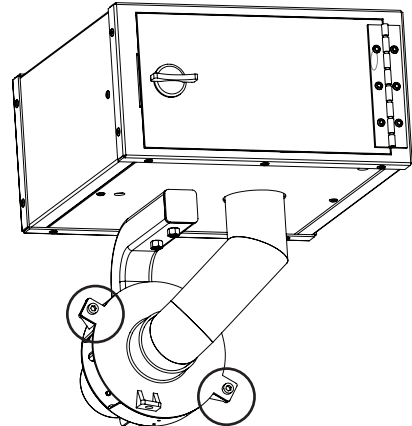

B REMOVING SPINNER ASSEMBLY

IF YOU DO NOT WISH TO RESTRICT THE FLOW OF FEED, PLEASE PROCEED TO SECTION E.

If you would like to restrict the amount of feed dispensed, a restrictor plate has been provided. In order to install the restrictor plate, the spinner assembly must be removed.

To remove, rotate the spinner assembly so the set screw faces the opening in the spinner housing. Next, insert a long 2mm hex key into set screw and turn counter-clockwise to loosen. Slide spinner assembly off of motor shaft.

Note: Restrictor plate limits the amount of material delivered to the spinner assembly. If the amount of feed being dispensed is too much, adding this restrictor plate is an effective way to decrease the volume of feed thrown.

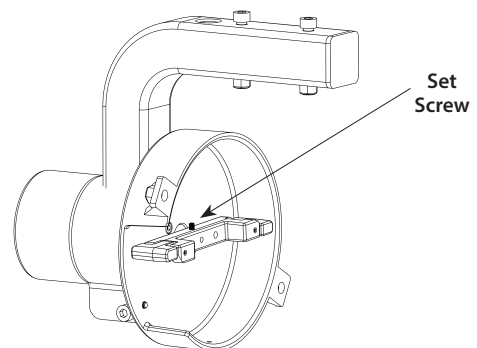

C INSTALLING RESTRICTOR PLATE

Using a 2.5mm hex key, install the 2.5mm screws as shown by turning clockwise attaching the restrictor plate to the spinner assembly.

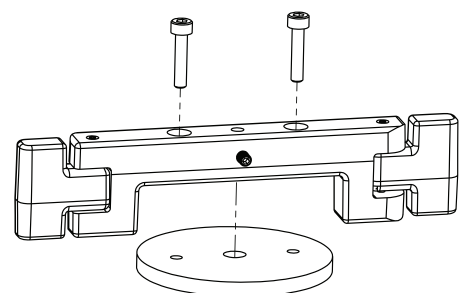

D RE-INSTALLATION OF SPIN PLATE ASSEMBLY

Slide the spinner plate back onto the motor shaft and install the previously removed set screw using a 2mm hex key (Allen Wrench).

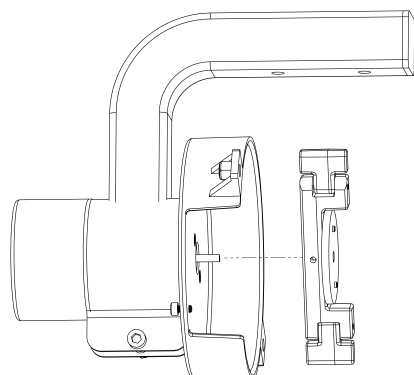



E ATTACHING FEEDER CHUTE

Line up the chute with the two bolt holes as shown, and mount the impeller cover and chute to the impeller housing using the hardware previously removed in Step A.

Also install provided 4mm screw and nut to bottom flange as shown in circled area.

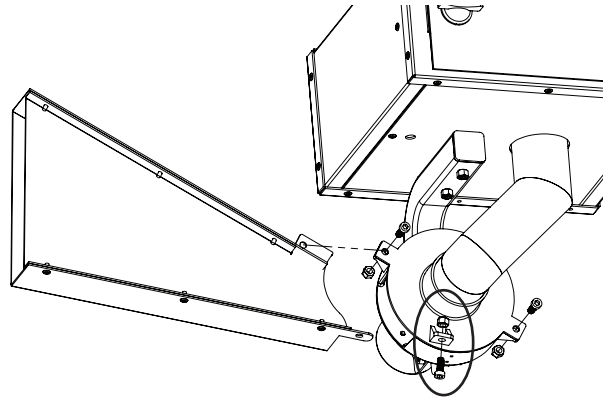

F ATTACHING FEEDER CHUTE CONTINUED

Use a 3mm hex key (Allen wrench) to attach included machine screw, flat washer, and lock washer to the chute and impeller housing.

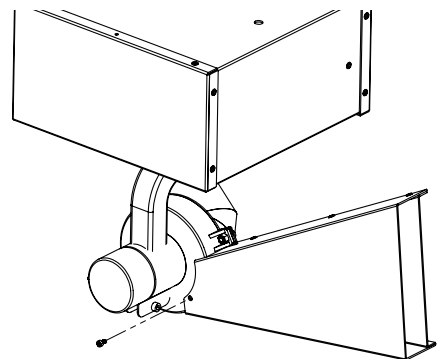

G ATTACHING ANTI-CLOG STRAINER

Note: If mounting to barrel or other non-Moultrie hopper, refer to Section H before installing anti-clog strainer.

Slide rubber washer onto the feed tube, then position the anti-clog strainer and bolts with matching holes on the top of the feeder kit box as shown in diagram. Fasten bolts using a 11mm socket wrench.

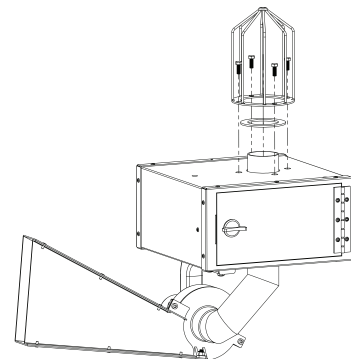

H MOUNTING THE FEEDER KIT

1 Align feeder kit to bottom of hopper, run the 3 (1/4"-20 x 4 3/4") black bolts through the holes at the bottom of the kit all the way through the top holes and into the barrel or hopper. Opening the battery door may assist when trying to align.

2 If mounting to a barrel or hopper other than the Moultrie Wildlife Directional Feeder, mounting the feeder kit will require drilling holes in the bottom of the barrel or hopper. Create a template of the bolt holes on the top of the feeder kit before installing the anti-clog strainer to ensure the holes are drilled in the correct pattern and orientation. After installing the strainer, fasten using the provided bolts, nuts, and washers on the inside of the barrel.

Note: The chute discharge angle can be slightly adjusted if necessary. Loosen the collar screw nut with a 10mm (3/8") socket and rotate the assembly.

DO NOT PUSH PAST THE SET SCREW.
IF YOU DO SO, YOU WILL DAMAGE YOUR FEEDER MOTOR.

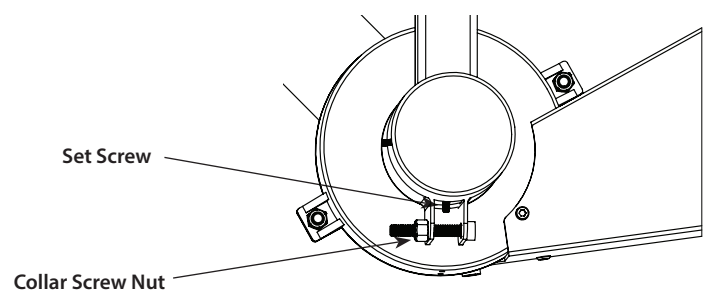
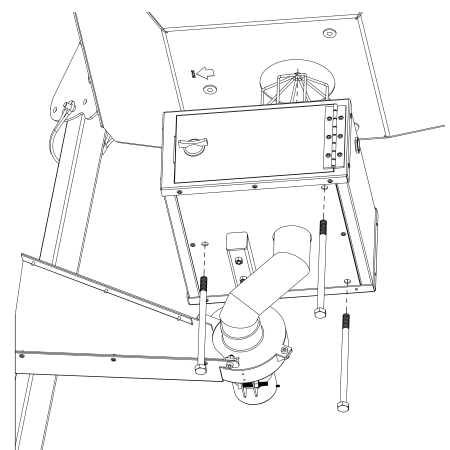

MOULTRIE®

Contact our U.S.-based customer service at www.moultriefeeders.com/contact-us





I

CONFIGURING AND TESTING FEEDER

Note: The switch on the bottom of the Timer needs to be set for 12V to ensure proper function.

1 INSTALL BATTERY: Open Kit by turning the knob on the battery door. Install a 12-Volt rechargeable (e.g. Energizer™) or Moultrie rechargeable battery (MCA-13093) by attaching the Red Wire Battery Connector to the positive terminal (+) and the Black Wire Battery Connector to the negative (-) terminal. The battery level is displayed every seven seconds. It is recommended that the battery be replaced/recharged when the %BATTERY reading is 25% or below.

2 SET TIME OF DAY: Press the UP or DOWN button until the correct time of day appears. Press and release button to single-step through the minutes or hold down to advance quickly.

3 SET FEED TIMES: Press the SET button until the correct timer number appears in the upper right hand corner as shown. Press the UP or DOWN button to set the feed time. **Note: Factory settings are 7am and 6pm.**

4 SET RUN DURATION: Press the SET button again to set the RUN-TIME SECONDS which can range from zero to twenty seconds. Adjust RUN-TIME SECONDS using the chart below. Set the RUN-TIME SECONDS to zero to disable the specific timer. **Note: Factory setting is 6 seconds.**

RUN TIME (sec.)	1	2	3	4	5	6	7	8	9	10	11	12	13	14	15	16	17	18	19	20
Approx. Feed Dispensed (lbs.)	.38	.62	.88	1.0	1.2	1.5	1.7	1.9	2.2	2.4	2.6	2.8	3.0	3.3	3.5	3.7	4.0	4.2	4.4	4.6

5 SET FEED LEVEL: Your feeder timer is equipped with a Feed Level Estimator. Press the SET button until “SET FEED REMAINING” appears. Enter the amount of feed (lbs.) added to Hopper. The timer will automatically estimate the amount of feed remaining in lbs. and days after auto-scroll begins.

Note: The above estimates are based on using deer corn. Feed type, size and density will affect calculations.

TEST FEEDER: PRESS AND HOLD the SET button while the RUN-TIME SECONDS are displayed. Release the button and get away from the feeder when the message “TESTING GET AWAY” appears on the display.

